

## Product Specifications

### Wall + Wood - 48" x 7"

US Ref.	Décor	Board Size	Thickness	UPC	Pack Qty	I 2of5
UT301F06	Cargo Wood	47.25"x6.80"	0.20"	014306937069	1	10014306937066
UT301F05	Hammam Wood	47.25"x6.80"	0.20"	014306937076	1	10014306937073

### Carton Information

Sq. Ft. Covered	Boards/ Unit Box	Unit Box Weight (lbs)	Unit Box Size (in.)	Unit Box/ plt	Pallet size	Pallet Wt. (lbs)	Pallets/ 53' truck	Unit Boxes/ 53' truck	Pallets/ 20' Container	Unit Boxes/ 20' Container	Pallets/ 40' Container	Unit Boxes/ 40' Container
22.17	10	22.05	48.25" x 7.75" x 2.1875"	75	51.18"x39.37"x39.37" (5 box/layer, 15 layers)	1726	24	1800	18	1350	24	1800

### Wall + Wood - 36" x 6"

US Ref.	Décor	Board Size	Thickness	UPC	Pack Qty	I 2of5
UT501G18	Light Gray Oak	47.25"x6.80"	0.20"	014306941592	1	10014306941599
UT501G20	Dark Oak	47.25"x6.80"	0.20"	014306941608	1	10014306941605

### Carton Information

Sq. Ft. Covered	Boards/ Unit Box	Unit Box Weight (lbs)	Unit Box Size (in.)	Unit Box/ plt	Pallet size	Pallet Wt. (lbs)	Pallets/ 53' truck	Unit Boxes/ 53' truck	Pallets/ 20' Container	Unit Boxes/ 20' Container	Pallets/ 40' Container	Unit Boxes/ 40' Container
21.8	15	20.8 lb.	36.5" x 6.9" x 3.25"									

## Décors and Trim



Cargo Wood

Hammam Wood



Light Gray Oak

Dark Oak

### Finishing & Angle Trims

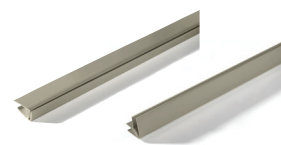

Incense Grey Trim

# Grosfillex®

# GX WALL+

## Faux Wood Wall Covering



## Features & Benefits

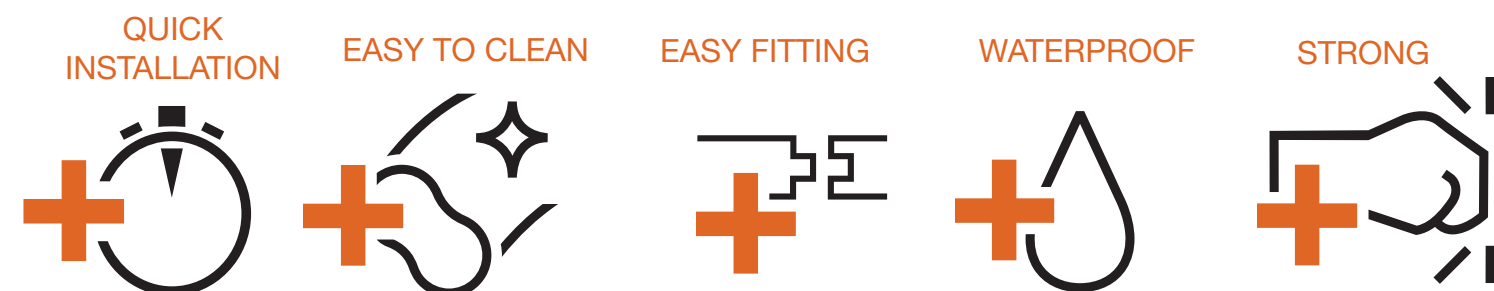

## Materials

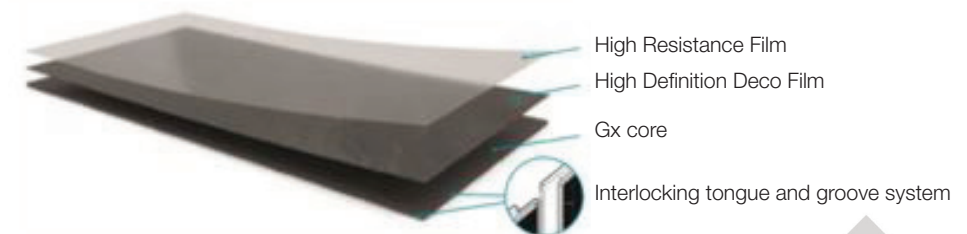

## Wall Paneling Testing - Grosfillex Wall+

	Test Description	Test	Performance
Fire	Resistance to Heat	ASTM F1514	Pass: AATCC 4.5 Slight chg
	Critical Radiant Flux	ASTM E648	Pass: Class 1
	Surface Burning Characteristics	ASTM E84	Pass: Class B
	Smoke Density	ASTM E662	Pass 367 & 403
Emission	Formaldehyde Emission	CDPH Std. Method V1.2	Compliant
	VOC Emission	CDPH Std. Method V1.2	Compliant
Resistance	Light Stability	ASTM F1515	Pass: AATCC 3.0 Noticeable
	Dimensional Stability	ASTM F2199	Pass: .29" to .38" Final Curl
	Scratch Resistance	ISO 1518-1 (Version 1)	Pass: Penetration at 29.4 newtons
	Abrasion Resistance	ASTM D4060	Pass: 1000g 5,200 cycles
	Anti-Bacterial / Microbial	ASTM G21	Pass: Rating=1 Traces of growth <10%
Waterproof	Water Penetration Test(s)	T-Seam test	Pass: No penetration 0.000mm Swell AATCC 5.0 No Change
	Water Penetration Test(s) with silicone	T-Seam test with silicone	Pass: No penetration 0.000mm Swell AATCC 5.0 No Change
Miscellaneous	Impact Sound Reduction (IIC)	ASTM E492 & E989	Pass: IIC 49
	Ortho-phthalates (Plasticizers)	California Prop 65 CPSAI	No labeling - No warning required
	Heavy Metals	ASTM F963	Pass: all <0.25



**MADE IN CHINA**

## Installation Instructions

### TOOLS - OUTILS - HERRAMIENTAS

Measuring - Pour mesurer - Measuring    Cutting - Pour couper - Para cortar    Fixing - Pour fixer - Para fijar

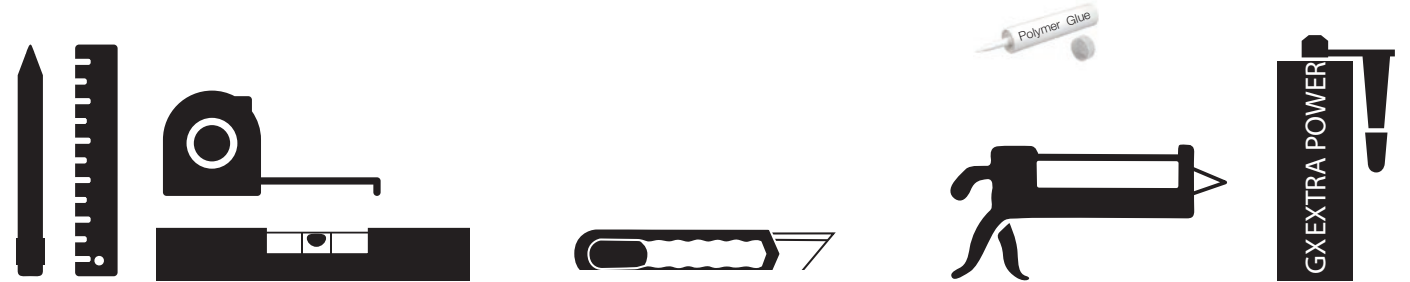

### INSTALLATION MANUAL - NOTICE DE POSE - PROSPECTO DE INSTALACIÓN

For further details visit [www.grosfillexus.com](http://www.grosfillexus.com) - Plus de détails sur [www.grosfillexus.com](http://www.grosfillexus.com) - Más detalles en [www.grosfillexus.com](http://www.grosfillexus.com)

## GX WALL+ WOOD

22.17 sqft / 2.06 m<sup>2</sup>    6<sup>4/5</sup> in / 17.2 cm    47<sup>1/4</sup> in / 120 cm    1/5 in / 0.5 cm    x10

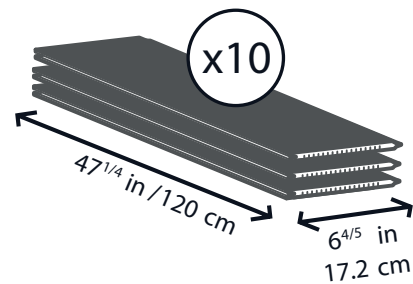

## GX WALL+ WOOD

22.17 sqft / 2.06 m<sup>2</sup>    6 in / 15 cm    35<sup>5/16</sup> in / 90 cm    1/5 in / 0.5 cm    x15

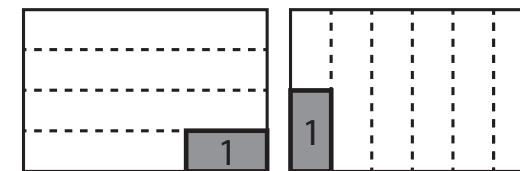
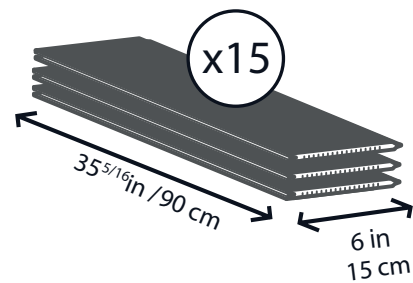

Horizontal or vertical positioning  
Pose horizontale ou verticale  
Instalación horizontal o vertical

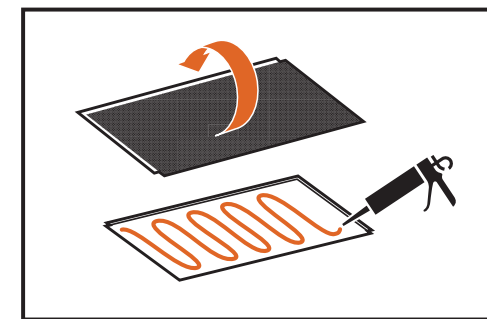

GB - Paste the glue onto the first panel  
FR - Encoller la première lame  
ES - Pegar la primera lámina

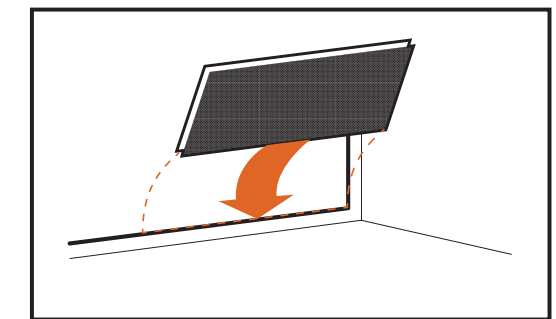

GB - Position the panel on the wall, correctly levelled  
FR - Positionnez la lame sur le mur, de niveau.  
ES - Coloque la lámina sobre la pared, de nivel.

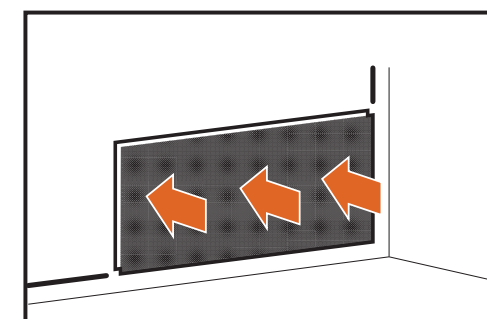

GB - Press over the entire length of the panel  
FR - Presser sur toute la surface de la lame  
ES - Presionar sobre toda la superficie de la lámina

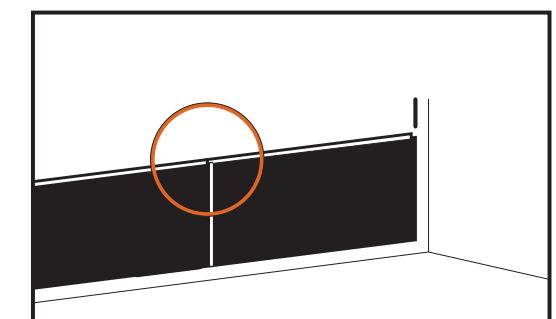

GB - Clip on the next panel and repeat the process  
FR - Emboîter la lame suivante et répéter l'opération  
ES - Encajar la lámina siguiente y repetir la operación

